

Installation Instructions

INSTALLATION ON GLASS AND GLASS WITH SOLAR FILM

1. For best results area must be cleaned.
2. Using Windex and a paper towel, clean the desired area. (a)
3. After cleaning once, re-spray area you wish to apply Paw-Gard. (a)
4. Peel the paper backing off Paw-Gard, and apply clear film to the same area. (b) (c)
5. Re-spray the Paw-Gard with Windex while holding the film in place with your index finger. (d)
6. Using a household squeegee, firmly pull it across the film horizontally and vertically until all the air pockets are gone. Remaining moisture will evaporate over the next few days.



INSTALLATION ON WOOD AND OTHER LIKE SURFACES

1. Clean area desired with Windex and a paper towel; be sure to wipe off all moisture. (a) (b)
2. Peel thin clear backing down about 5 or 6 inches. Tack the edge at the highest point of needed protection. (c) (d)
3. With the palm of your hand, push down the Paw-Gard as you peel the liner from the remainder of the film. This smoothing process will adhere Paw-Gard to the door. (e)
4. If a wrinkle should start to form, peel back from the nearest corner to the wrinkle and smooth back down.

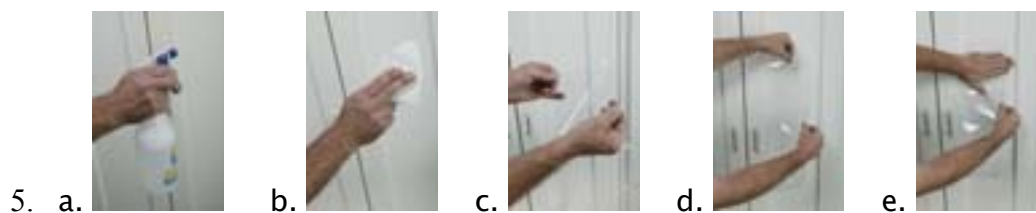

For customer support call our toll free number (866) (Paw-Gard) 729-4273.